



**EQUIPAMIENTO PARA VESTUARIOS**  
*FIXTURES & FITTINGS FOR LOCKER ROOM*

---



### 8.1. Bancos para vestuario

8.05 Estructuras bancos para vestuario

### 8.1. Changing room bench

8.05 Structures changing room benchLine

### 8.2. Herrajes para vestuarios

- 8.09 Herrajes para cabinas sanitarias
- 8.12 Perfiles de aluminio para cabinas sanitarias
- 8.14 Herrajes para taquillas
- 8.16 Bisagras de cazoleta Ø26
- 8.18 Pies para taquillas

### 8.2. Changing room fittings

- 8.09 Toilet Partition fittings
- 8.12 Aluminium profiles for toilet partition fittings
- 8.14 Locker fittings
- 8.16 Hinges with Ø26 cup
- 8.18 Feet partition hardware



## BANCOS PARA VESTUARIO

8.05 Estructuras bancos para vestuario

### CHANGING ROOM BENCH

8.05 Frames changing room bench

Estructuras para bancos de vestuario realizadas en aluminio acabado plata mate, concebidos para realizarlos con tableros de fenólico de 12 / 13mm de espesor y fijados mediante tornillos pasantes suministrados con la estructura.

*Structures for changing room benches made from matt aluminium plate, designed to be used with 12 - 13 mm thick phenol board and fixed with screws provided with the structure.*

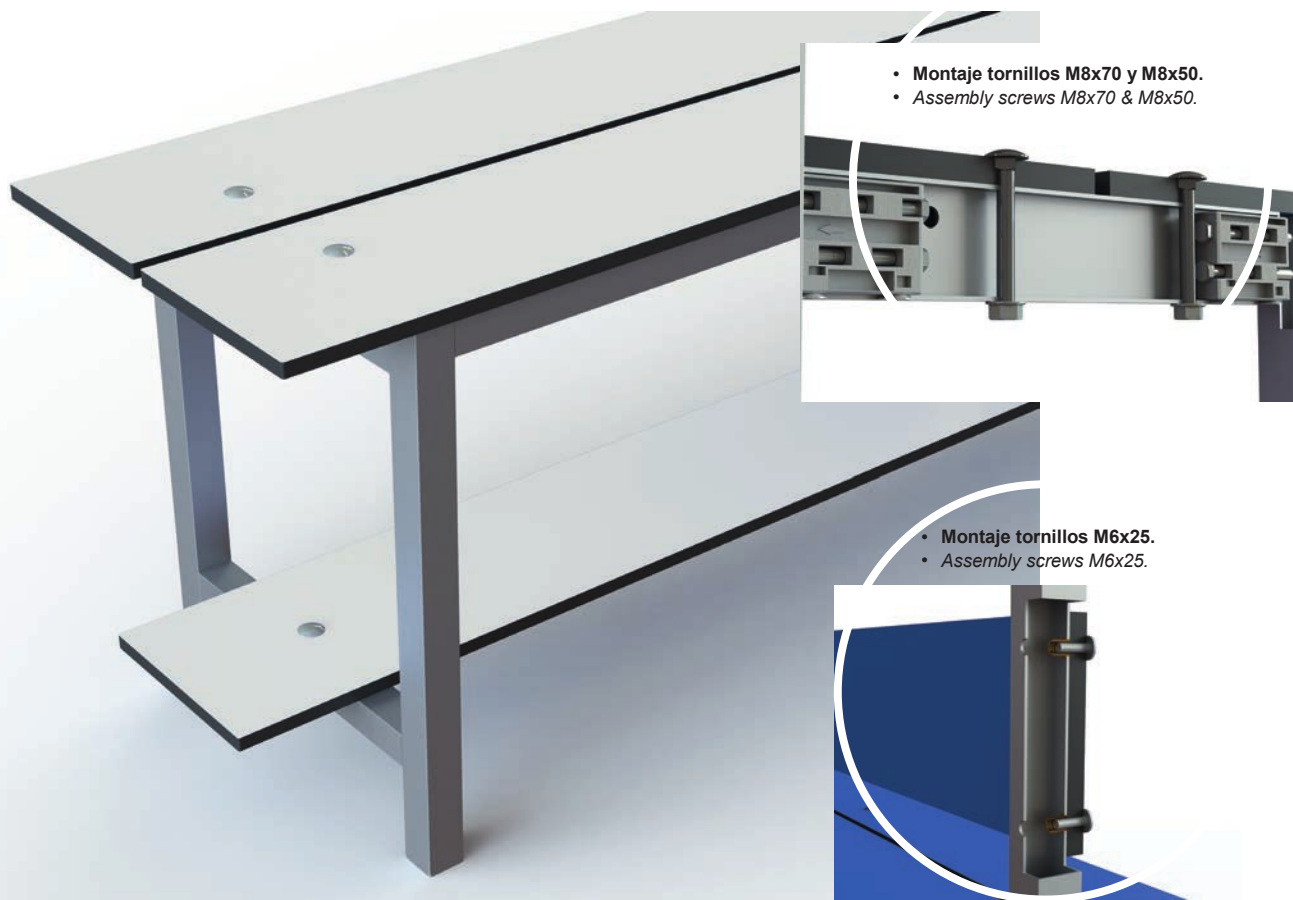

**palbox**

**BANCOS VESTUARIO****CHANGING ROOM BENCH****Lateral banco simple***Lateral single bench*Cod. 

80216 62 1

Aluminio / Aluminium

**Incluido en el pack:**

- Incluye 4 tornillos M8x70 DIN 603
- Incluye 2 tornillos M8x50 DIN 603
- Incluye 6 tuercas M8 DIN 603

*Included in the pack:*

- 4 screws M8x70 DIN 603
- 2 screws M8x50 DIN 603
- 6 nuts M8 DIN 603

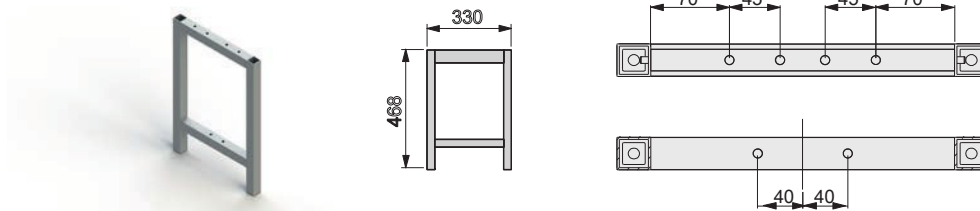
**Lateral Banco simple con Perchero***Lateral of Single bench with hook*Cod. 

80217 62 1

Aluminio / Aluminium

**Incluido en el pack:**

- Incluye 4 tornillos M8x70 DIN 603
- Incluye 2 tornillos M8x50 DIN 603
- Incluye 6 tuercas M8 DIN 603
- Incluye 4 tornillos M6x25 DIN 603

*Included in the pack:*

- 4 screws M8x70 DIN 603
- 2 screws M8x50 DIN 603
- 6 nuts M8 DIN 603
- 4 screws M6x25 DIN 603

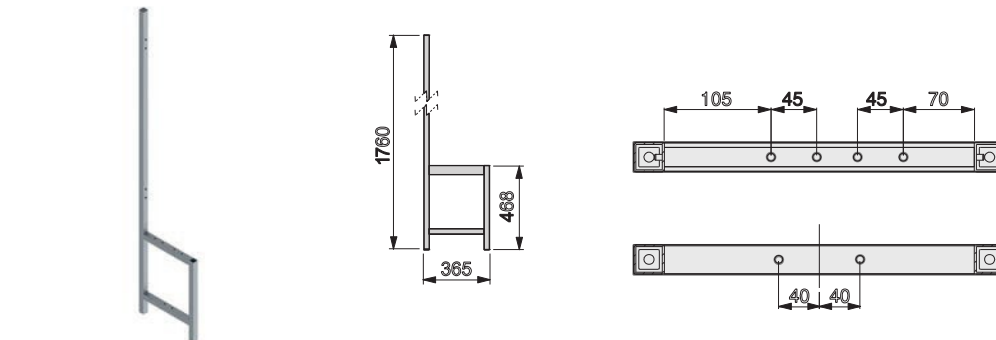
**Lateral Banco simple con Perchero y Altillo***Lateral of Single bench with hook and top shelf*Cod. 

80218 62 1

Aluminio / Aluminium

**Incluido en el pack:**

- Incluye 4 tornillos M8x70 DIN 603
- Incluye 2 tornillos M8x50 DIN 603
- Incluye 6 tuercas M8 DIN 603
- Incluye 4 tornillos M6x25 DIN 603

*Included in the pack:*

- 4 screws M8x70 DIN 603
- 2 screws M8x50 DIN 603
- 6 nuts M8 DIN 603
- 4 screws M6x25 DIN 603

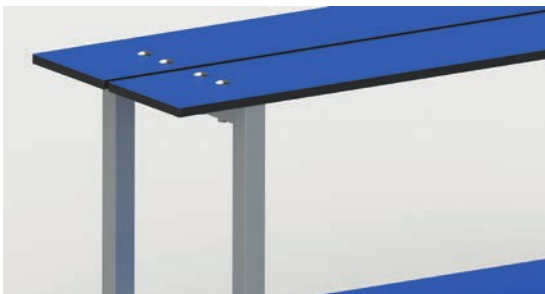
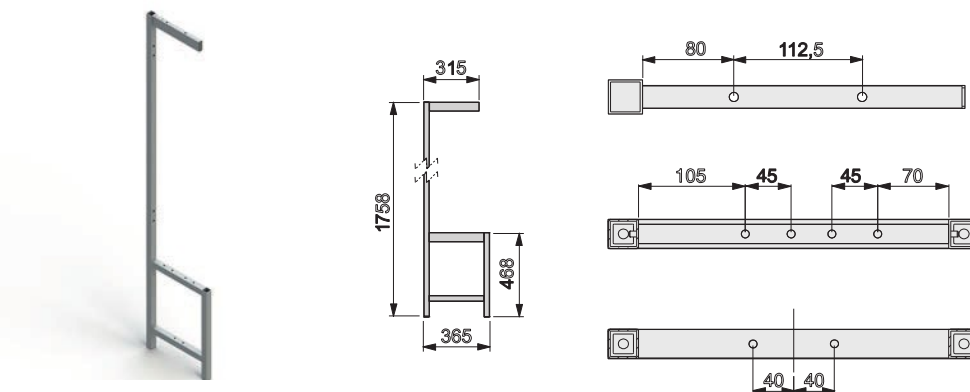

Consultar otras posibles medidas y acabados.  
Possibility of others measurements and finishes on request.



Nivelador recomendado Cod.3057464  
Leveller recommended Cod.3057464



**BANCOS VESTUARIO**  
CHANGING ROOM BENCH

**Lateral Banco doble con perchero**

Lateral of Single bench with hook

Cod. 



80219	62	1
-------	----	---

Aluminio / Aluminium

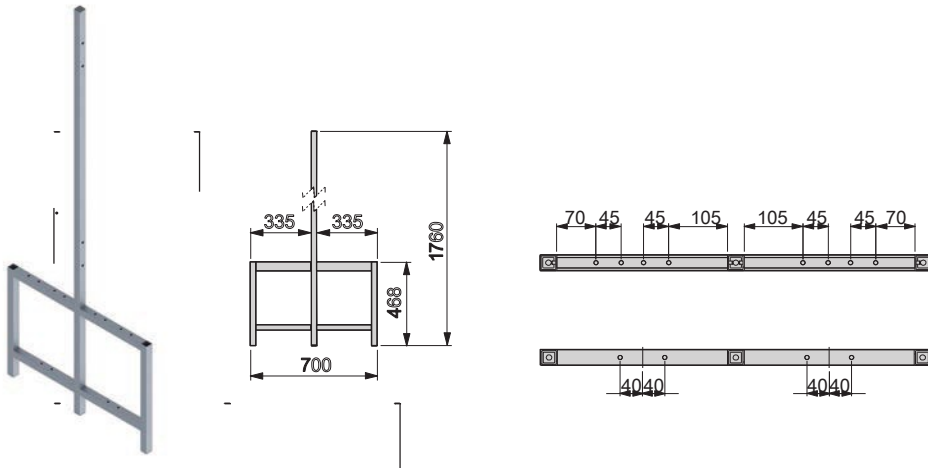

**Incluido en el pack:**

- Incluye 8 tornillos M8x70 DIN 603
- Incluye 4 tornillos M8x50 DIN 603
- Incluye 12 tuercas M8 DIN 603
- Incluye 8 tornillos M6x25 DIN 603

*Included in the pack:*

- 8 screws M8x70 DIN 603
- 4 screws M8x50 DIN 603
- 12 nuts M8 DIN 603
- 8 screws M6x25 DIN 603

**Lateral Banco doble con perchero y Altillo**

Lateral of Single bench with hook and top shelf

Cod. 



80220	62	1
-------	----	---

Aluminio / Aluminium

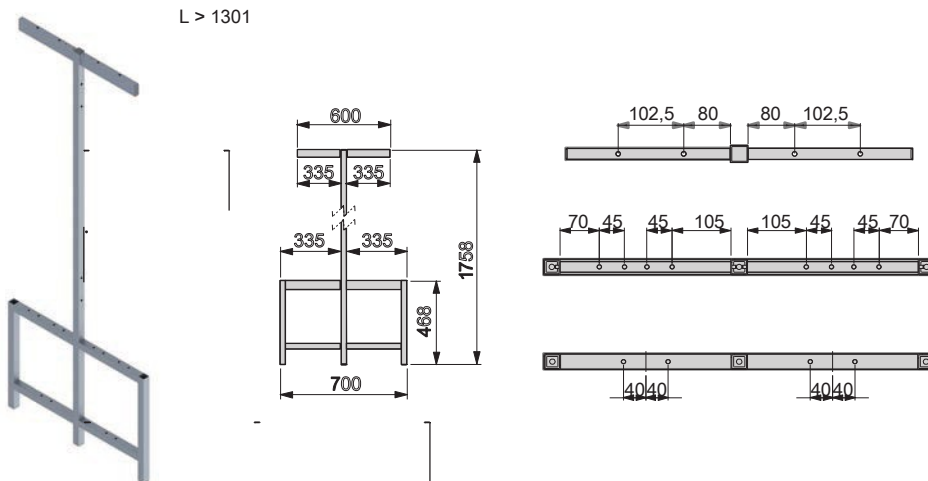

**Incluido en el pack:**

- Incluye 8 tornillos M8x70 DIN 603
- Incluye 4 tornillos M8x50 DIN 603
- Incluye 12 tuercas M8 DIN 603
- Incluye 12 tornillos M6x25 DIN 603

*Included in the pack:*

- 8 screws M8x70 DIN 603
- 4 screws M8x50 DIN 603
- 12 nuts M8 DIN 603
- 12 screws M6x25 DIN 603

Consultar en las posibles medidas y acabados  
Possibility of others measurements and finishes

Nivelador recomendado Cod.3057464  
Leveler recommended Cod.3057464

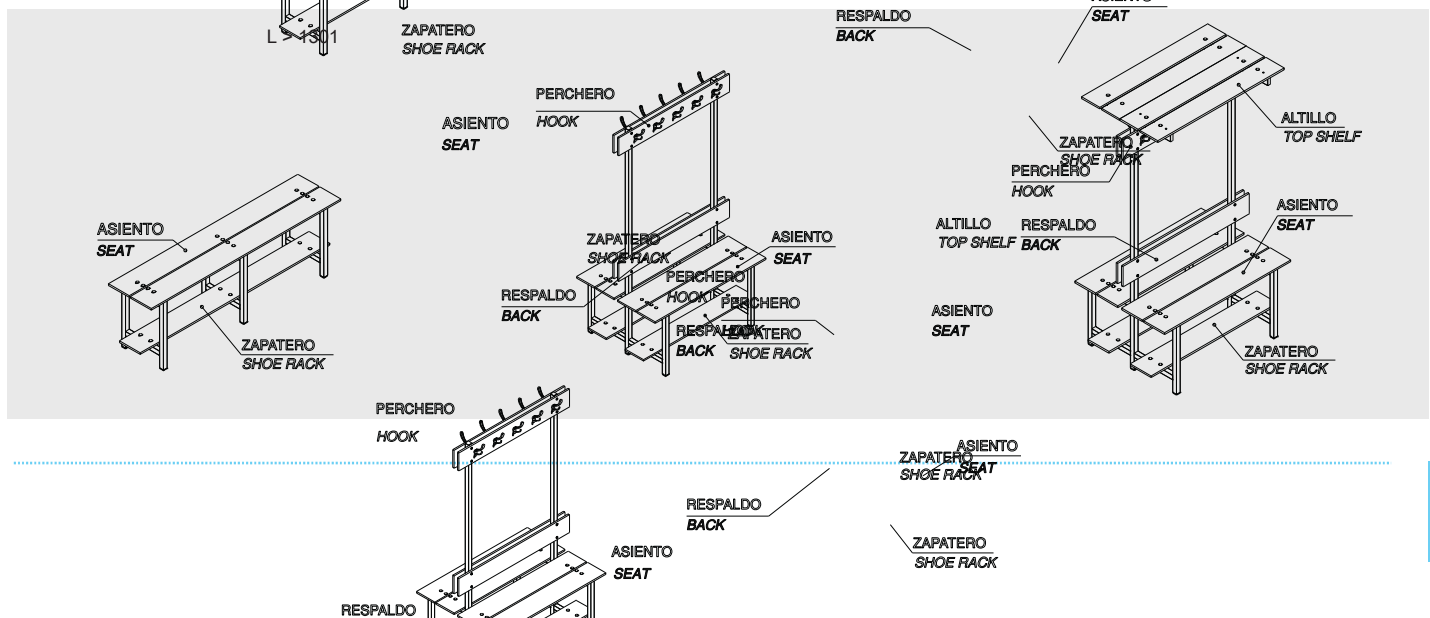

### Banco simple

Single bench

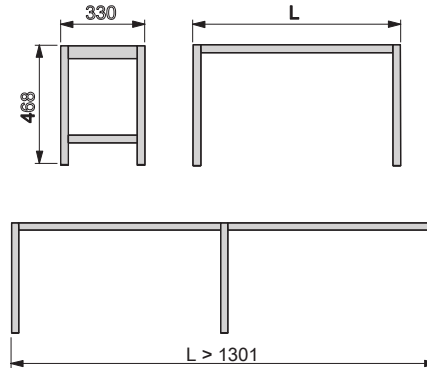

Tamaño Size	L	Cod.		
1000	800	80200	62	1
1500	1300	80201	62	1
2000	1800	80202	62	1

Aluminio / Aluminium

- "L" hasta 1300 - Incluye 4 tornillos M8x70, 2 tornillos M8x50 y 6 tuercas M8.
- "L" mayor de 1301 - 6 tornillos M8x70, 3 tornillos M8x50 y 9 tuercas M8
- "L" until 1300 - 4 Screws M8x70, 2 Screws M8x50 and 6 nuts M8
- "L" more than 1301 - 6 Screws M8x70, 3 Screws M8x50 and 9 nuts M8

### Banco simple con perchero

Single bench with hook

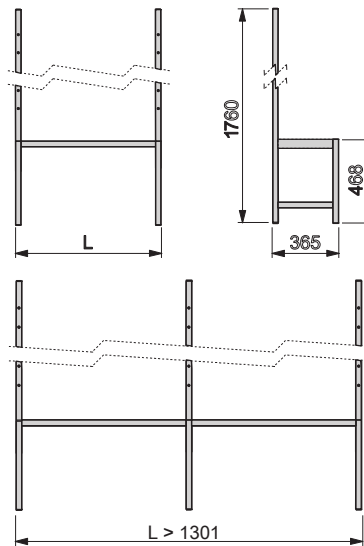

Tamaño Size	Perchas Hooks	L	Cod.		
1000	5	800	80203	62	1
1500	8	1300	80204	62	1
2000	10	1800	80205	62	1

Aluminio / Aluminium

- "L" hasta 1300 - Incluye 4 tornillos M8x70, 2 tornillos M8x50, 6 tuercas M8 y 8 Tornillos M6x25.
- "L" mayor de 1.301 - 6 tornillos M8x70, 3 tornillos M8x50, 9 tuercas M8 y 12 tornillos M6x25.
- Se incluyen las perchas (ver tabla).
- "L" until 1300 - 4 Screws M8x70, 2 Screws M8x50, 6 nuts M8 and 8 screws M6x25.
- "L" more than 1.301 - 6 Screws M8x70, 3 Screws M8x50, 9 nuts M8 and 12 Screws M6x25.
- Hooks included (See Table).

### Banco simple con perchero y altillo

Single bench with hook and top shelf

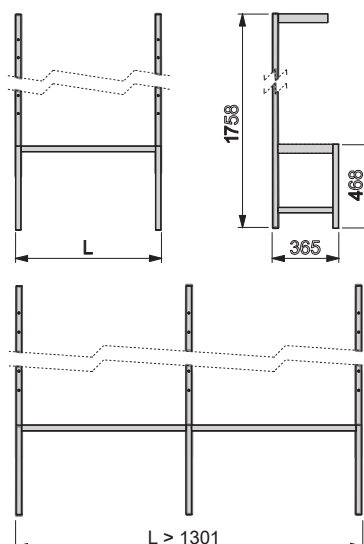

Tamaño Size	Perchas Hooks	L	Cod.		
1000	5	800	80206	62	1
1500	8	1300	80207	62	1
2000	10	1800	80208	62	1

Aluminio / Aluminium

- "L" hasta 1300 - Incluye 4 tornillos M8x70, 2 tornillos M8x50, 6 tuercas M8 y 12 Tornillos M6x25.
- "L" mayor de 1.301 - 6 tornillos M8x70, 3 tornillos M8x50, 9 tuercas M8 y 18 tornillos M6x25.
- Se incluyen las perchas (ver tabla).
- "L" until 1300 - 4 Screws M8x70, 2 Screws M8x50, 6 nuts M8 and 12 screws M6x25.
- "L" more than 1.301 - 6 Screws M8x70, 3 Screws M8x50, 9 Nuts M8 and 18 Screws M6x25.
- Hooks included (See Table).

Consultar otras posibles medidas y acabados  
 Possibility of others measurements and finishes

Nivelador recomendado Cod.3057464  
 Leveller recommended Cod.3057464

**Banco doble con perchero**

Double bench with hook

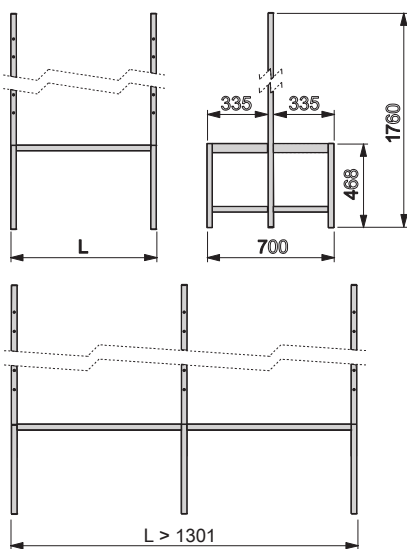

Tamaño Size	Perchas Hooks	L	Cod.		
1000	10	800	80209	62	1
1500	16	1300	80210	62	1
2000	20	1800	80211	62	1

Aluminio / Aluminium

- "L" hasta 1300 - Incluye 8 tornillos M8x70, 4 tornillos M8x50, 12 tuercas M8 y 16 Tornillos M6x25.
- "L" mayor de 1301 incluye - 12 tornillos M8x70, 6 tornillos M8x50, 18 tuercas M8 y 24 tornillos M6x25
- Se incluyen las perchas (ver tabla)
- "L" until 1300 include - 8 Screws M8x70, 4 Screws M8x50, 12 nuts M8 and 16 screws M6x25.
- "L" more than 1301 include - 12 Screws M8x70, 6 Screws M8x50, 18 Nuts M8 and 18 Screws M6x25 .
- Hooks included (See Table).

**Banco doble con perchero y altillo**

Double bench with hook and top shelf

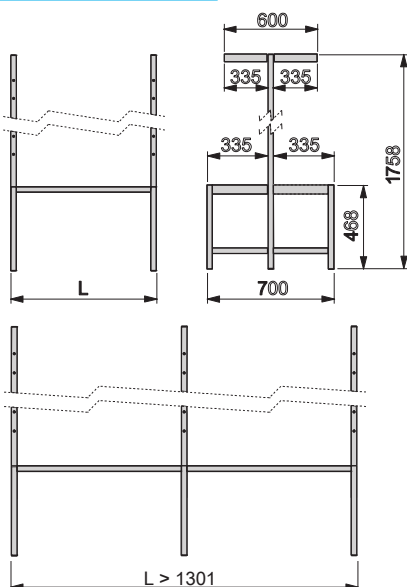

Tamaño Size	Perchas Hooks	L	Cod.		
1000	10	800	80212	62	1
1500	16	1300	80213	62	1
2000	20	1800	80214	62	1

Aluminio / Aluminium

- "L" hasta 1300 - Incluye 8 tornillos M8x70, 4 tornillos M8x50, 12 tuercas M8 y 24 Tornillos M6x25.
- "L" mayor de 1301 incluye - 12 tornillos M8x70, 6 tornillos M8x50, 18 tuercas M8 y 36 tornillos M6x25
- Se incluyen las perchas (ver tabla)
- "L" until 1300 include - 8 Screws M8x70, 4 Screws M8x50, 12 nuts M8 and 24 screws M6x25.
- "L" more than 1301 include - 12 Screws M8x70, 6 Screws M8x50, 18 Nuts M8 and 36 Screws M6x25 .
- Hooks included (See Table).

Consultar otras posibles medidas y acabados  
Possibility of others measurements and finishes

Nivelador recomendado Cod.3057464  
Leveller recommended Cod.3057464

**Colgador**

Coat and Hat Hook

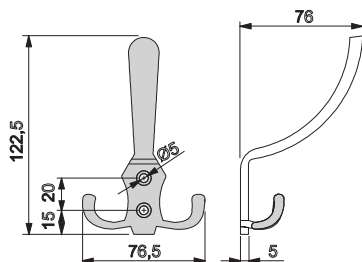

Cod.		
80115	64	200

Zamak / Zamak

- Incluye 2 tornillos
- Include 2 Screws



# 8.2

09/27

## HERRAJES PARA VESTUARIOS

- 8.11 Herrajes para cabinas sanitarias
- 8.17 Perfiles de aluminio para cabinas sanitarias
- 8.19 Herrajes para taquillas
- 8.24 Bisagras de cazoleta Ø26
- 8.25 Pies para taquillas

## CHANGING ROOM FITTINGS

- 8.11 Toilet Partition fittings
- 8.17 Aluminium profiles for toilet partition fittings
- 8.19 Toilet partition hardware
- 8.24 Hinges with Ø26 cup
- 8.25 Feet partition hardware

Solución para la realización de baños y vestuarios de una manera rápida y sencilla.

Los herrajes están realizados en Acero Inox. AISI-304 y pensados para paneles de fenólico de 12-13mm.

*Solution for the layout of toilets and changing rooms in a quick and easy way.*

*Fittings made in Stainless Steel AISI-304 and designed to be used with 12-13 mm thick phenol board*

sifer

palbox

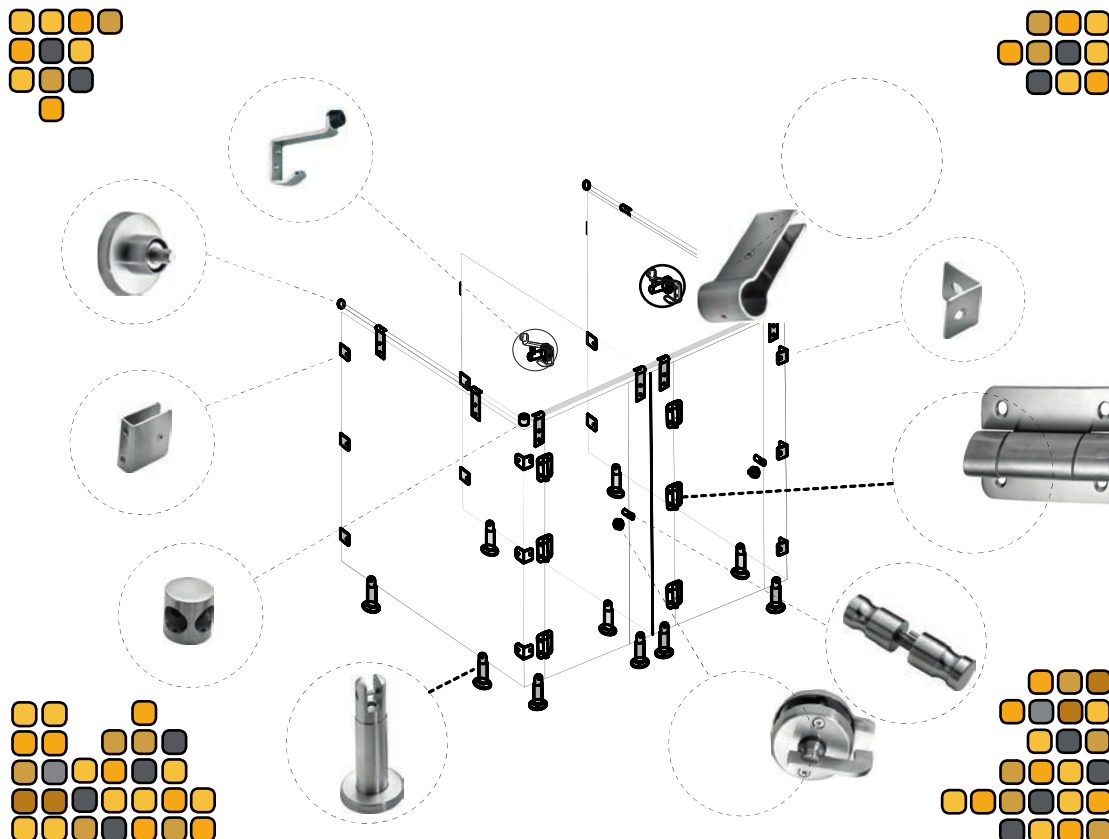



**sifer**

**palbox**

**HERRAJES PARA CABINAS SANITARIAS**  
**TOILET PARTITION FITTINGS**

**Pata regulable 100/180**

Adjustable support leg 100/180

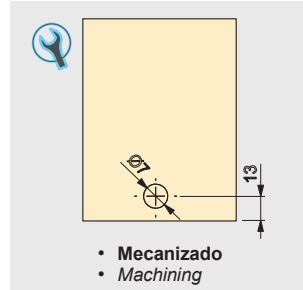

Acero. / Steel	Cod.	65	4
AISI-304	85000	65	4
AISI-316	85018	65	4

Acero Inx. / Stainless steel

- Incluye 3 tornillos con tacos.
- Include 3 screws with plastic anchor.

**Soporte Tubo Ø25 a pared**

Support tube Ø25- to wall

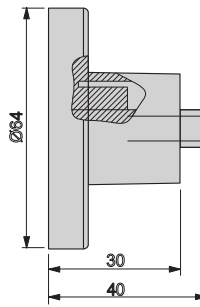

Cod.	65	10
85001	65	10

Acero Inx. / Stainless steel

- Incluye 3 tornillos con tacos.
- Include 3 screws with plastic anchor.

**Pinza union Tubo Ø25 a panel**

Hanging clamp tube Ø25 to board

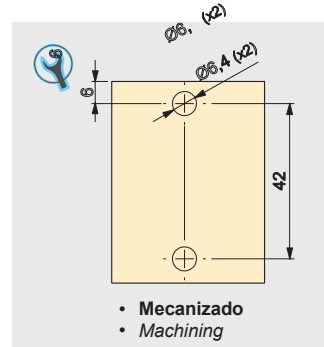
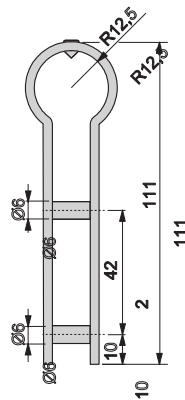

Cod.	65	10
85002	65	10

Acero Inx. / Stainless steel

**Nudo conexión tubo Ø25**

Hanging clamp tube Ø25

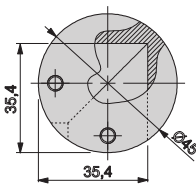
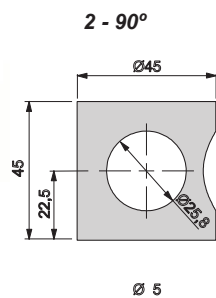

Conesión / Conexion	Cod.	65	6
2-90°	85003	65	6
3-180°	85004	65	6

Acero Inx. / Stainless steel

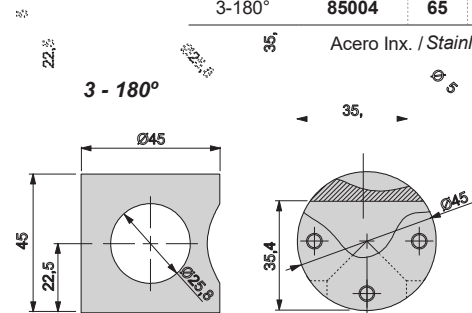

**Bisagra Cabina 90x52x2**

Cabin Hinger 90x52x2

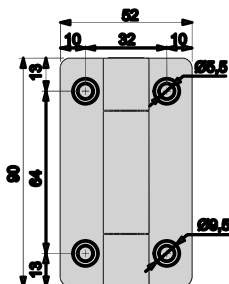

Versión Version	Cod.	
Con muelle With spring	85005	65   10
Sin muelle Without spring	85006	65   10

Acero Inx. / Stainless steel

- Tornillo recomendado Cod. 8300865
- Screw recommend Cod. 8300865

**Jgo. Pomos diametro 25**

Kit Door Handle Diameter 25



Cod.	
85007	65   10

Acero Inx. / Stainless steel

- Incluye llave Allen.
- Include hexagonal key.

**Condena Plana con Indicador**

Door Lock with Indicator

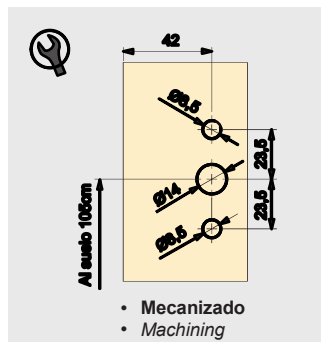

- Mecanizado
- Machining

Cod.	
85008	65   1

Acero Inx. / Stainless steel

- Incluye llave Allen.
- Include hexagonal key.

**Percha con Tope**

Cloths Hanger

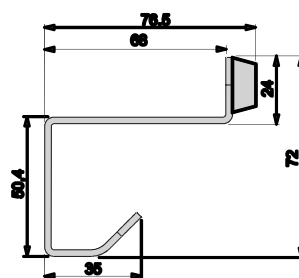
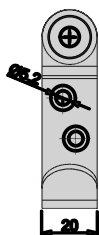

Cod.	
85009	65   4

Acero Inx. / Stainless steel

- Para panel fenólico se recomienda tornillo Cod. 8300865
- For Phenol board it's recommend screw Cod. 8300865

**Pinza Union Lateral 50x50**

Lateral Support 50x50

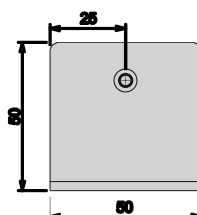

Cod.	
85010	65   10

Acero Inx. / Stainless steel

- Tornillo recomendado Cod. 8300865
- Screw recommend Cod. 8300865

**Escuadra de unión lateral 43x43**

Corner fastener 43x43

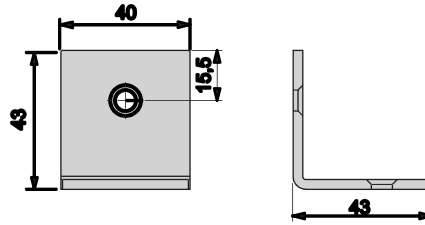

Cod.		
85011	65	10
Acero Inx. / Stainless steel		

- Tornillo recomendado Cod. 8300865
- Screw recommend Cod. 8300865

**Perfil L 30x30 Acero Inox**

Stainless Steel profile L 30x30

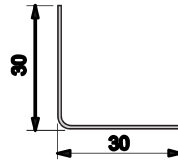

	Cod.	
1,8 m	85012	65 20
Acero Inx. / Stainless steel		

- Tornillo recomendado Cod. 8300865
- Screw recommend Cod. 8300865

**Perfil U 20x16 Acero Inox**

Stainless Steel profile U 20x16

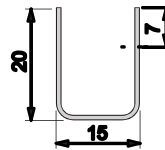
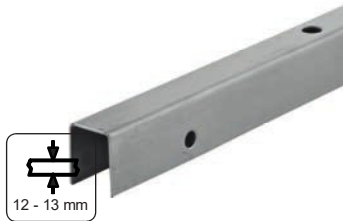

	Cod.	
1,8 m	85013	65 20
Acero Inx. / Stainless steel		

- Tornillo recomendado Cod. 8300865
- Screw recommend Cod. 8300865

**Tubo Ø25 Acero Inox**

Stainless Steel tube Ø25

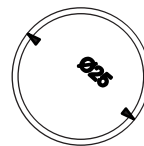

	Cod.	
3 m	85014	65 10
Acero Inx. / Stainless steel		

**Unión Tubo Ø25**

Tube union Ø25

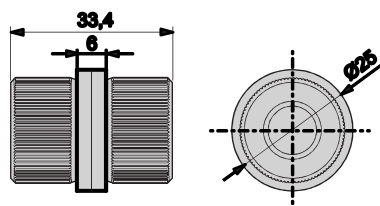

Cod.		
85015	65	5
Acero Inx. / Stainless steel		

**PUERTA CORREDERA CABINA SANITARIA**  
**TOILET PARTITION SLIDING DOOR**

**Sistema Puerta Corredera**  
**Kit Carriage Sliding Door**



	Cod.			
1,9 m	85022	62	69	1



x 2



x 4



x 2



x 2

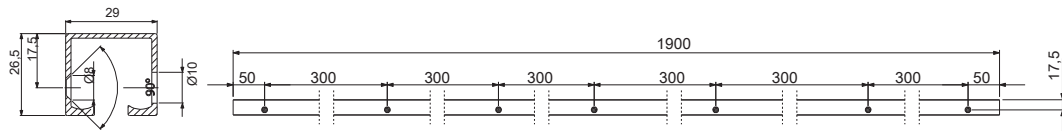
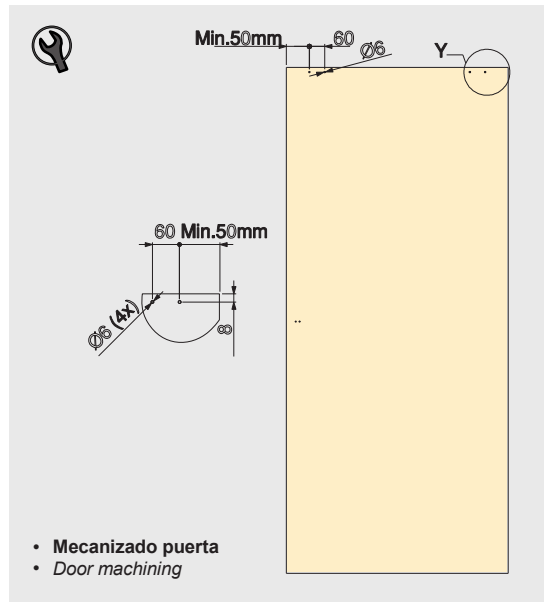

- Perfil se sirve mecanizado.
- Machining included on the profile.

**Cierre Suave 50 kg**  
**Soft Closing 50kg**

Cod.	
20905	21
	1

Acero y plástico / Steel and plastic



Tuerca remachable M4  
 Rivetnut M4

Tornillo M4x10  
 Screw M4X10

**POSIBILIDADES MONTAJE GUÍA**  
**TOP TRACK ASSEMBLY**

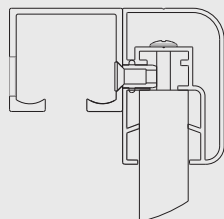

- Config. perfil remate superior
- Top Profile config.

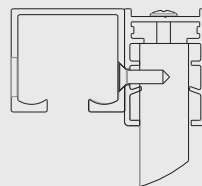

- Config. remate con perfil soporte
- Support panel profile. config.

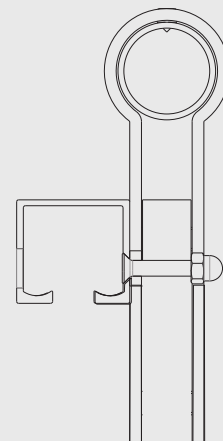

- Config. fijación con pinza
- Hanging clamp config.

**Hoja de Pedido Perfil Remate superior**

*Top Profile Data Sheet*

**Apertura izquierdas / Left opening**

**Apertura derechas / Right opening**

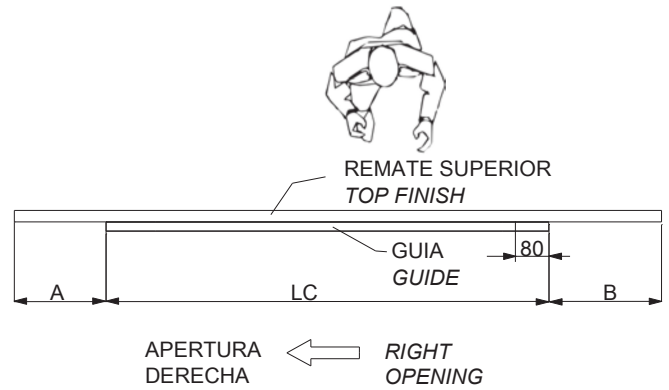
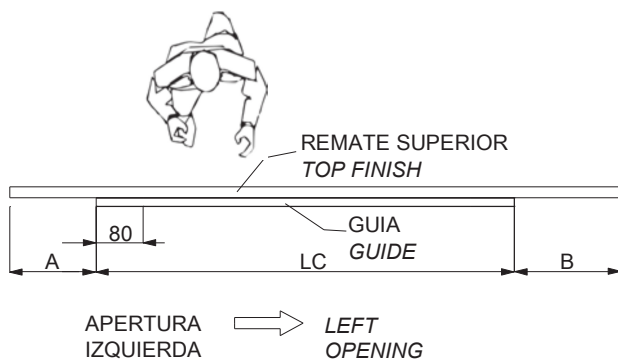
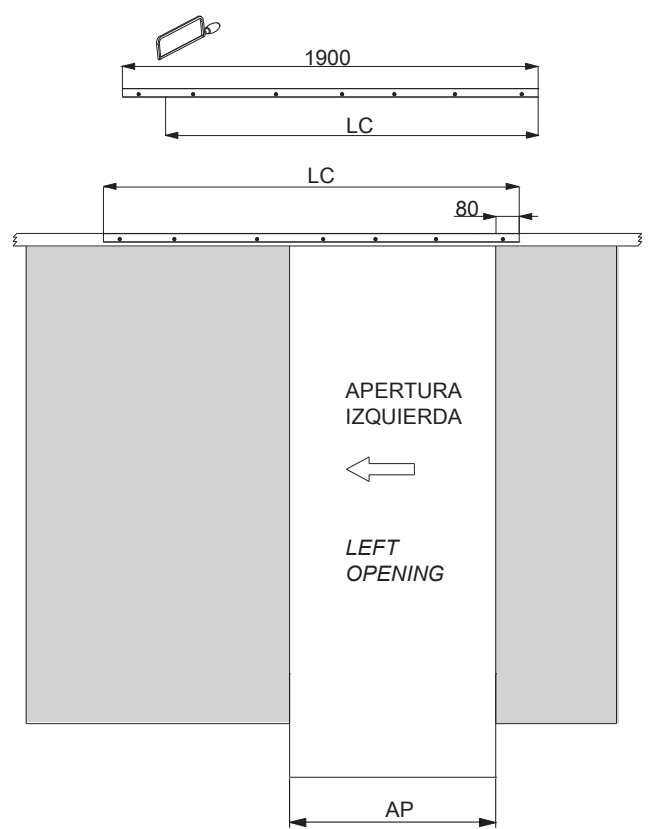
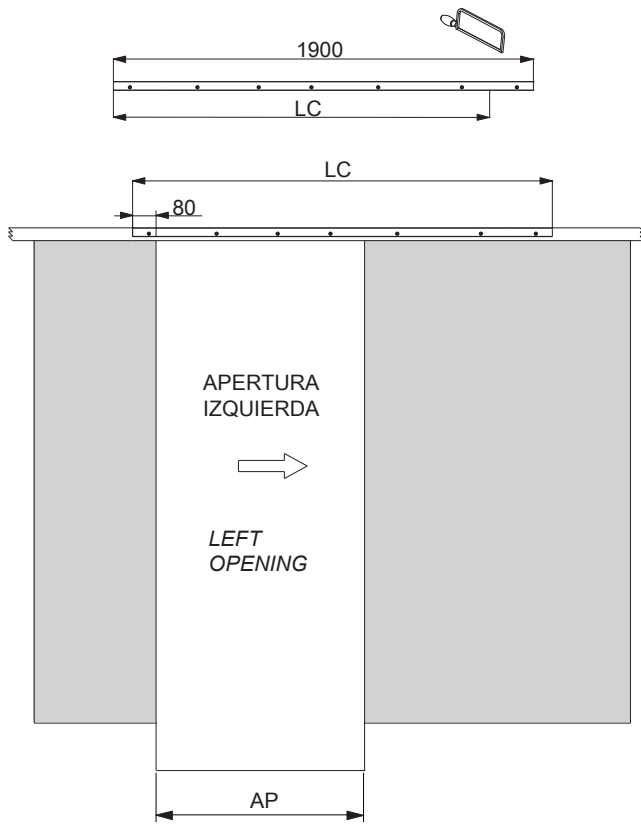

	L	LC	A	B	AP
<b>Medidas</b> <i>Measurements</i>					

	L	LC	A	B	AP
<b>Medidas</b> <i>Measurements</i>					

**L= Longitud remate superior**  
*L= Top profile length*

**LC = Longitud de corte**  
*LC= Cutting Length*

**AP= Ancho hueco**  
*AP= Overall width*



**Juego Condena Puerta Corredera con Tirador**

Sliding Door Kit Lock With Indicator

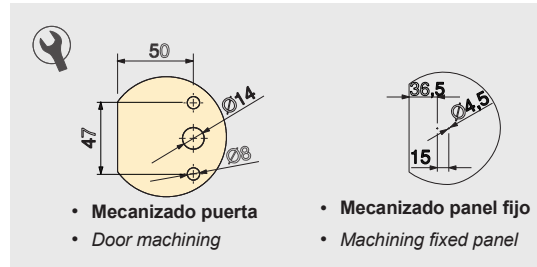

Cod.		
85019	65	1
Acero Inx. y zamak Stainless steel and Zamak		



**Distanciador para Condena**

Door Lock Distancing

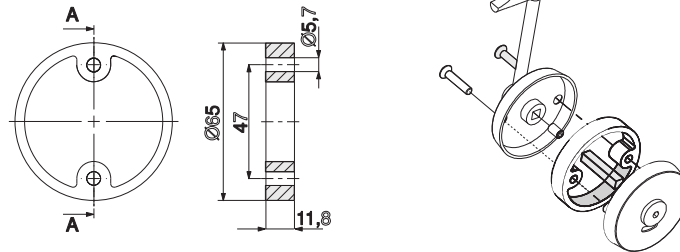

Cod.		
85020	65	1
Zamak / Zamak		

**Condena Puerta Corredera**

Sliding Door Lock With Indicator

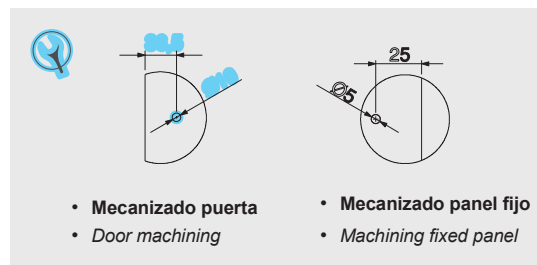

Cod.		
85024	65	1
Acero Inx. / Stainless steel		



**Juego de puerta corredera**

Kit sliding door

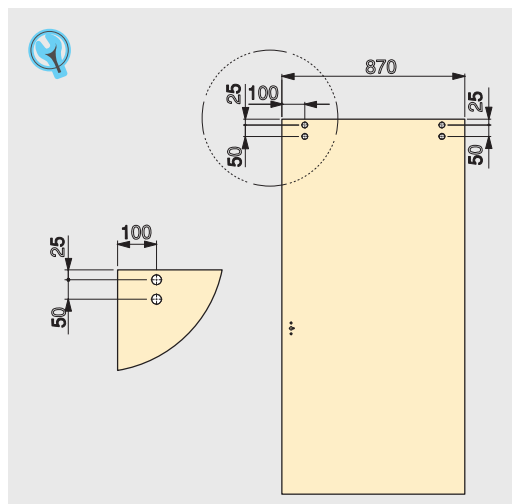

Cod.		
85016	65	1
Acero Inx. / Stainless steel		



**PERFILES DE ALUMINIO PARA CABINAS SANITARIAS**  
**ALUMINIUM PROFILES FOR TOILET PARTITION FITTINGS**

**Per. Cantonera 90° 30x30 Al Inx Sat**  
*Profile connector 90° 30x30 Al Inx Sat*



L	Cod.	62	69	8
1,8 m	83000	62	69	8
1,85 m	83014	62	69	8
2,85 m	83001	62	69	⊙ m

Aluminio / Aluminium

- Montaje sin tornillos en la cara exterior.
- Assembly without screws on the external face.

**Perfil Soporte Panel Al Inx Sat**  
*Support panel profile Al Inx Sat*



L	Cod.	62	69	8
1,8 m	83022	62	69	8
1,85 m	83023	62	69	8
3 m	83002	62	69	8
3,05 m	83003	62	69	⊙ m

Aluminio / Aluminium

- Posibilidad de unión a inglete con Escuadra Cod. 9984720
- Possibility miter joint with Bracket Cod. 9984720

**Perfil Remate Superior Al Inx Sat**  
*Top Profile Al Inx Sat*



L	Cod.	62	69	8
3 m	83004	62	69	8
3,05 m	83005	62	69	⊙ m

Aluminio / Aluminium

- Posibilidad de unión a inglete con Escuadra Cod. 8300720
- Possibility miter joint with Bracket Cod. 8300720

**Regulador altura**  
*Height regulator*

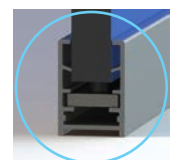
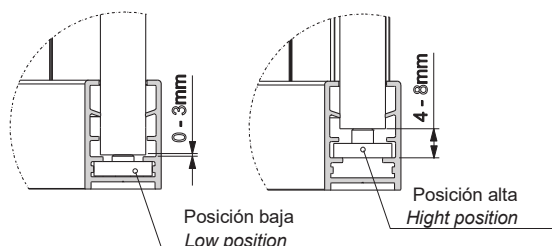

Cod.	20	1
83006	20	1

Acero / Steel

**Escuadra Sop. Panel**

Support Panel bracket

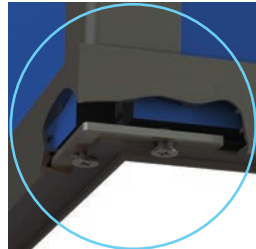

Cod.		
99847	20	1
Acero / Steel		

**Escuadra Remate Sup.**

Top Profile Bracket

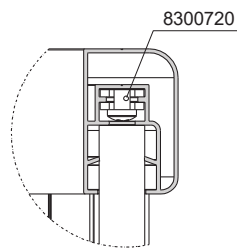

Cod.		
83007	20	1
Acero / Steel		

**Tornillo Cabeza Redonda Ø3.5x9.5 Inox**

Roundhead Screw Ø3.5x9.5 Inx

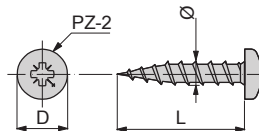

Ø	D	L	Cod.		
3,5	6,9	9,5	83008	65	1.000
4,2	8,2	9,5	83009	65	1.000

Acero Inx. / Stainless steel

- Tornillo recomendado para la fijación de panel fenólico
- Screw recommended for the fixation of phenolic board

**Tornillo Pasante M5**

Set Through Screw M5

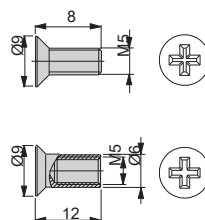

Cod.		
83030	65	500
Acero Inx. / Stainless steel		

## HERRAJES PARA TAQUILLAS TOILET PARTITION FITTINGS

### Perfil Taquilla Locker Profile

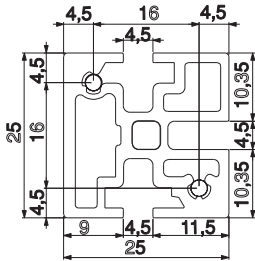

- Posibilidad de montar nivelador de M6.
- Possibility of mounting M6 leveler.

	Cod.		
1,8	83015	62	14,4m
2,85	83010	62	⊙ m.

Acero Inx. / Stainless steel

- Bisagra recomendada Cod.8301320
- Recommended hinge Cod.8301320

Permite la realización de taquillas con fenólico de 4mm de espesor.  
Allow lockers with phenolic 4mm thickness.

### Kit Bisagra Inx. Taquilla kit Locker Hinge Inx.

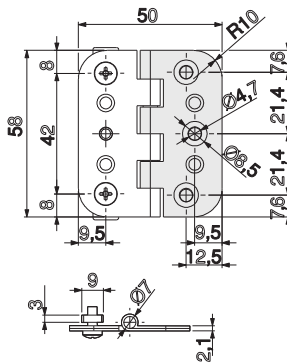

- Embalaje bolsa de 2 juegos, las piezas se sirven por separado.
- Packaging plastic bag with 2 set, the pieces are served separately.

Cod.		
83013	20	2

### Perfil L10 x 15 Profile L10 x 15

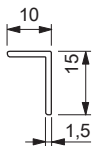

	Cod.		
3,2	79191	62	64

Acero Inx. / Stainless steel

### Escuadra Soporte Estante Shelf Support

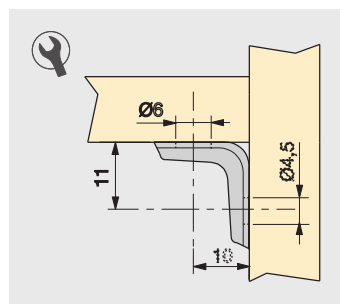
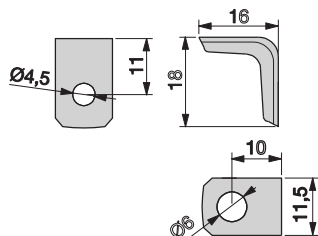

Cod.		
60066	07	2.000

Acero / Steel

## HERRAJES PARA TAQUILLAS

### LOCKER FITTINGS

#### Cerradura electronica

Electronic lock

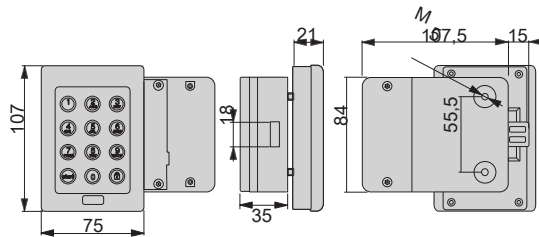

Mano Hand	Cod.		
Derecha Right	<b>83024</b>	<b>20</b>	1
Izquierda Left	<b>83025</b>	<b>20</b>	1

Plástico / Plastic

- Sistema touch
- Incluye 4 pilas 1,5V. Autonomía de 2 años.
- Protección en frontal IP-56. Protección contra impacto mecánico IK09.

- Touch system
- Included 4 batteries 1.5 V. 2 years of autonomy.
- Frontal protection IP-56. Mechanical impact protection IK09.

#### Cerradura CODE

CODE lock



Mano Hand		Cod.		
der / right	4 - 12	<b>80500</b>	<b>14</b>	10
izq / left	4 - 12	<b>80501</b>	<b>14</b>	10
der / right	16 - 20	<b>80502</b>	<b>14</b>	10
izq / left	16 - 20	<b>80503</b>	<b>14</b>	10

Acero y plástico / Steel and plastic

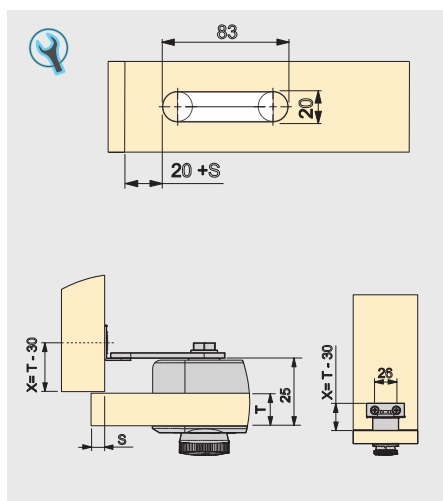

- Cada pedido incluye una llave de mantenimiento Cod. 8050405
- Each order includes one maintenance key Cod. 8050405

**Cerradura 2651**

Lock 2651

T	L	Cod.		
Max. 16mm	25	83020	07	20
Max. 20mm	30	83021	07	20

Acero / Steel

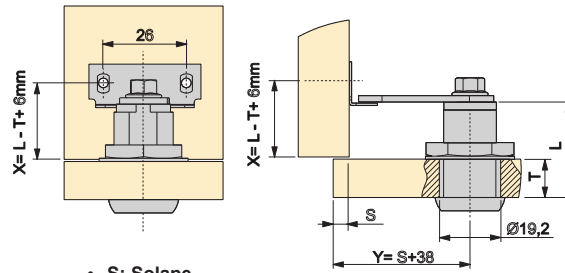

- S: Solape.
- S: Overlay.

**Escuadra cerradura 2651**

Lock square 2651

Cod.		
83012	07	20

Acero / Steel



**Llave maestra azul**

Blue Master Key

Cod.		
70109	20	1

Latón y Plástico  
Brass and Plastic



- Para cerradura 2651.
- For lock 2651.

**Cerradura candado Ø6-7 CRO**

Padlock 6-7mm diameter CRO

Cod.		
83026	11	1

Zamak y acero  
Zamak and Steel

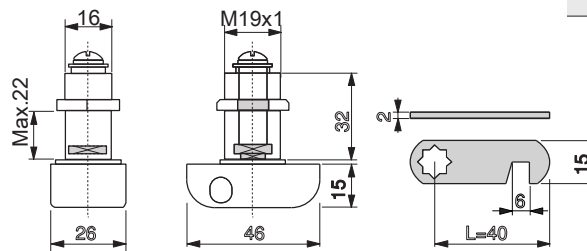

- Candado arco Ø6-7mm. Utilizar con el cod. 8302914
- For lock Ø6-7mm. Use with cod. 8302914

**Cerradura candado Ø8 CRO**

Padlock 8mm diameter CRO

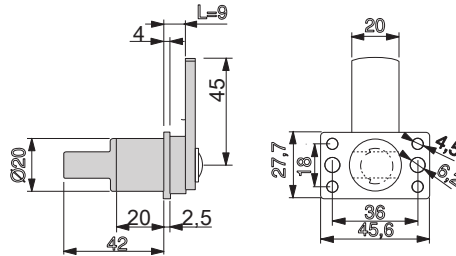

Mano Hand	Cod.		
Derecha Right	83027	11	1
Izquierda Left	83028	11	1

Zamak y acero  
Zamak and Steel

- Candado arco Ø8mm. Utilizar con el cod. 8302914
- 60.000 ciclos segun directrices LGA
- For lock Ø8mm. Use with cod. 8302914
- 60.000 cycles according to directives LGA

**Candado combinación de 3 dígitos NE**

Combination hasp lock 3 digit NE

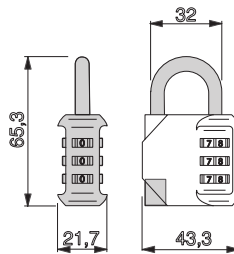

Cod.		
83029	14	1

Zamak y acero  
Zamak and Steel

- Arco de Ø6,2mm.
- For lock Ø6,2mm

**Cerradura Moneda**

Lock Coin

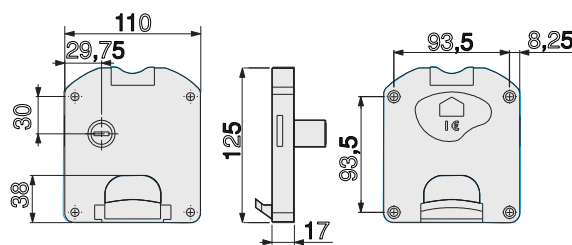

Mano Hand	Cod.		
Derecha Right	83017	14	1
Izquierda Left	83018	14	1

Zamak y Plastico  
Zamak and Plastic

**Escuadra Cerradura Moneda**

Lock Coin Square

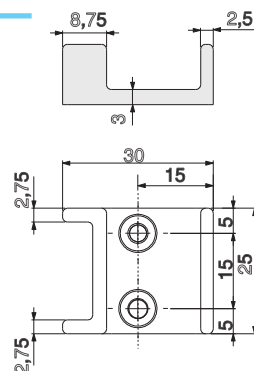

Cod.		
83019	14	1

Zamak /Zamak

**COMPLEMENTOS PARA TAQUILLA**  
**ACCESSORIES FOR LOCKER**

**Tubo de aluminio**

Aluminium rail

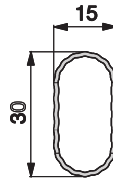

	Cod.	
4 m	62202 62	10 m
Aluminio / Aluminium		

**Soporte**

Support

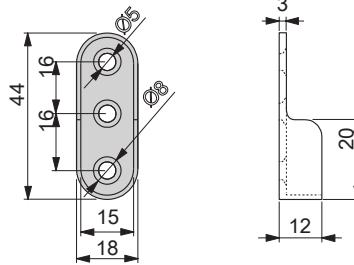

Cod.	
90723 07	500
Zamak / Zamak	

**Soporte antivandálico**

Anti-vandal support

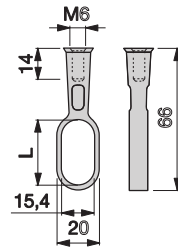

L	Cod.	
30	81203 25	500
Zamak / Zamak		

**Tornillo M6**

M6 screw

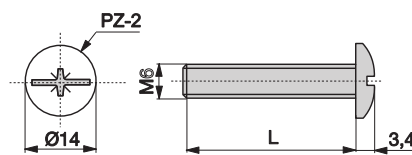

L	Cod.	
20	50221 07	2.000
Acero / Steel		

- Tornillo recomendado Cod. 5022107
- Screw recommend Cod. 5022107



**BISAGRAS DE CAZOLETA Ø26**

**HINGES WITH Ø26 CUP**

**Bisagra recta**

Full overlay hinge

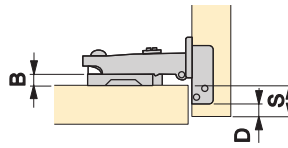
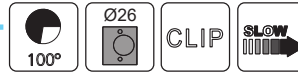

$$B = 12,5 + D + S$$

Descripción Description	Cod.		
Atornillar Screw-on	10084	07	200
A presión Ø10 Knock-in Ø10	10087	07	200

Acero / Steel

- **Suplemento NO incluido.**
- **Plate NOT included.**

**Bisagra Supercodo**

Insert hinge

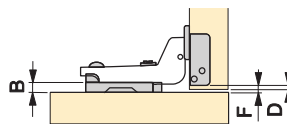
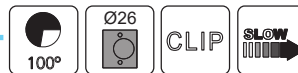

$$B = D + 15 - 4$$

Descripción Description	Cod.		
Atornillar Screw-on	10086	07	200
A presión Ø10 Knock-in Ø10	10089	07	200

Acero / Steel

- **Suplemento NO incluido.**
- **Plate NOT included.**

**Suplemento para atornillar**

Screw-on plate

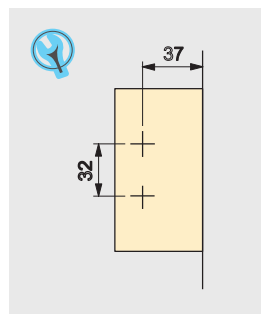

Altura Height	Cod.		
0	10025	07	200
2	10026	07	200

Acero / Steel

- **Regulación ±2mm**
- **Adjustable by ±2mm.**
- **Para panel fenólico se recomienda tornillo Cod. 8300865**
- **For Phenol board it's recommend screw Cod. 8300865**

**Suplemento montaje mixto**

Mixed mounting plate

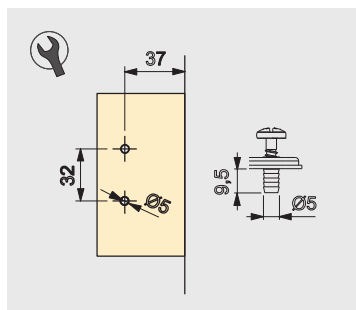

Altura Height	Cod.		
0	12520	07	200
2	10578	07	200

Acero / Steel

- **Regulación ±2mm**
- **Adjustable by ±2mm.**



**PIES PARA TAQUILLAS**

**FEET PARTITION HARDWARE**

**Pie 100-180**

Foot 100-180

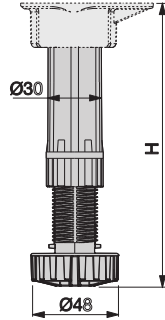

Altura Zócalo Altura Rodapé	H	Cod.		
100 - 120	98 - 140	<b>39118</b>	<b>17</b>	100
120 - 150	118 - 160	<b>39119</b>	<b>17</b>	100

Plástico/ Plastic

**Base montaje mediante Tornillo**

Screw mounting base

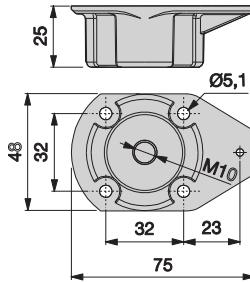

Cod.

<b>39121</b>	<b>17</b>	100
--------------	-----------	-----

Plástico/ Plastic

**Pinza para zocalos montaje directo/tornillo**

Direct-screw mounting clip for plinth

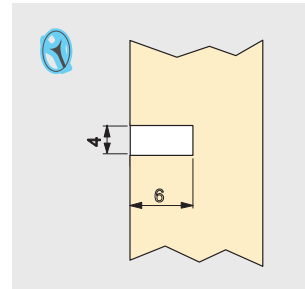
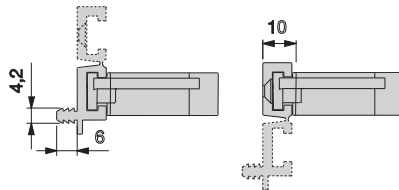

Cod.

<b>39129</b>	<b>17</b>	200
--------------	-----------	-----

Plástico/ Plastic

**Tornillo M10**

M10 screw

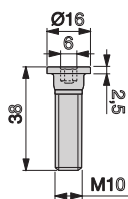

Cod.

<b>39126</b>	<b>05</b>	200
--------------	-----------	-----

Acero / Steel

**Tapón**

Cap

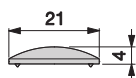

Cod.

<b>39127</b>	<b>15</b>	200
--------------	-----------	-----

Plástico/ Plastic

**Alumix 1**

Alumix 1

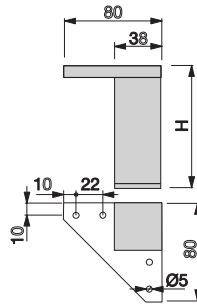

H	Cod.			
80	31676	-	25	20
100	31675	11	25	20

Plástico / Plastic

**Alumix 7**

Alumix 7

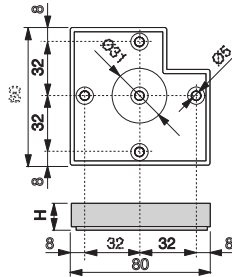

H	Cod.			
15	31185	25	25	20
30	31186	25	25	20
45	31187	25	25	20

Plástico / Plastic

- Posibilidad de combinarse entre sí consiguiendo así la altura deseada.
- Alumix may be combined to achieve the desired height.

**Tubo Prisma**

Prisma tube

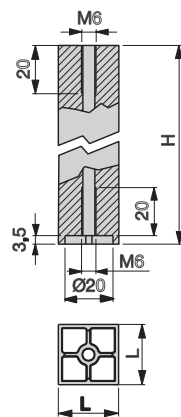

L	H	Cod.		
38	90	30858	62	24
38	130	30860	62	24

Aluminio / Aluminium

**Base Prisma**

Base Prisma

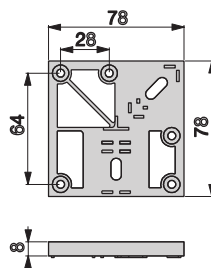

Cod.		
30790	25	24

Zamak / Zamak

**Tornillo Prisma**

Prisma screw

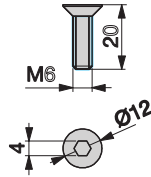

Cod.			
30749	09	24	

Acero / Steel

**Nivelador M6**

M6 leveller

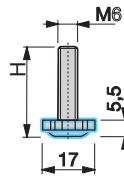

H	Cod.			
15	30520	17	24	
20	30807	17	24	

Acero y plástico  
Steel and plastic

**Nivelador M6**

M6 leveller

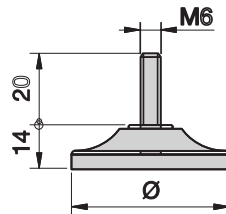

Ø	Cod.			
35	30809	25	24	
43	30811	25	24	

Acero / Steel

**Nivelador M10**

M10 leveller

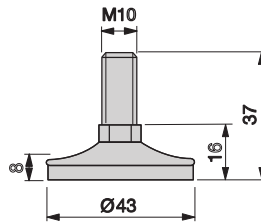

Cod.			
30574	64	100	

Acero y plástico  
Aço e plástico

**Filtro adhesivo**

Adhesive felt

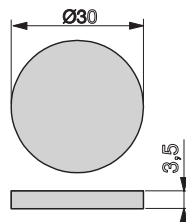

Cod.			
20042	16	630	

Fibra / Fibre





**NOTAS**  
NOTAS

Lined area for notes with horizontal lines.

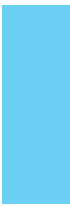

---

The logo for Sifer, featuring the word "sifer" in a bold, blue, lowercase sans-serif font. A small, circular globe icon is positioned above the letter 'i'.

**sifer**

[www.sifer.es](http://www.sifer.es)

The logo for Palbox industrial, featuring the word "palbox" in a bold, dark grey, lowercase sans-serif font, followed by the word "industrial" in a lighter grey, lowercase sans-serif font. To the right of the text is a stylized yellow graphic element consisting of three curved, overlapping shapes.

**palbox** industrial

[www.palbox.es](http://www.palbox.es)